

DATA SHEET

S5LPL1365/LED

Correctal® TA/1.0
telecentric lens
with c-mount / fixed iris

no picture available

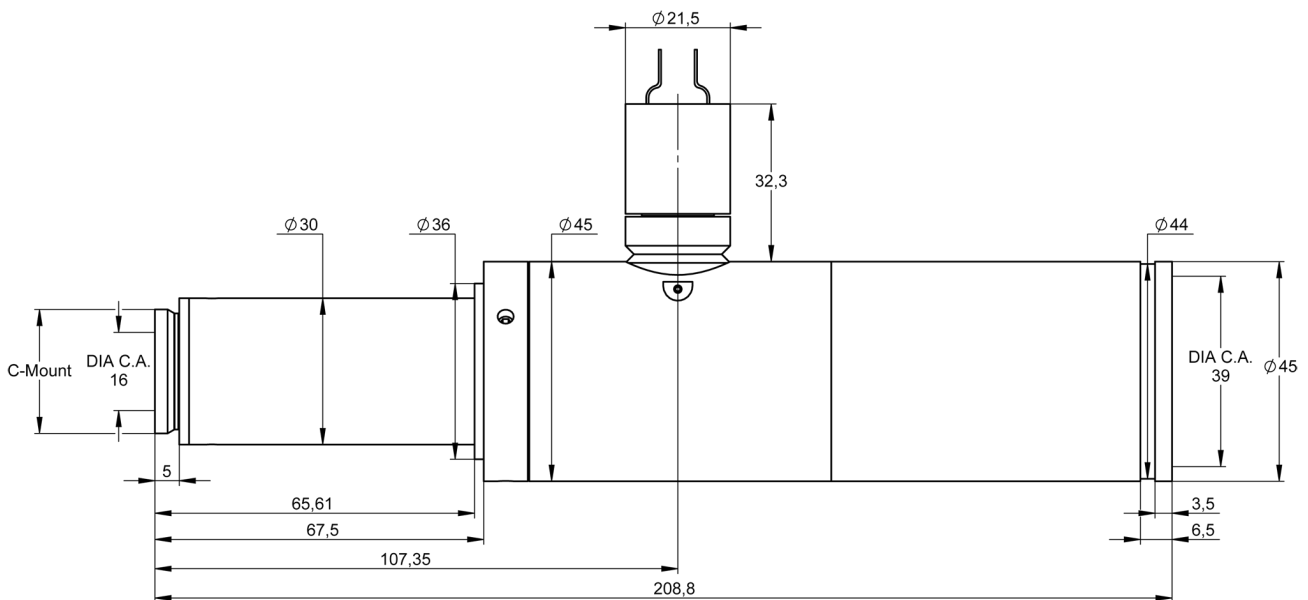

outline drawing

other adapter on special request

S5LPL1365/LED

Correctal® TA/1.0 telecentric lens with c-mount / fixed iris

| Specifications | |
|---|---|
| part number | S5LPL1365/LED |
| magnification (+/-5%) | 1.0 |
| working distance [mm] (+/-2%) | 256.0 |
| max. object size [mm] at a chip size of [mm] distorsion [%] | 4.8 x 3.6 4.8 x 3.6 (1/3") 0.05 |
| max. object size [mm] at a chip size of [mm] distorsion [%] | 6.4 x 4.8 6.4 x 4.8 (1/2") 0.05 |
| max. object size [mm] at a chip size of [mm] distorsion [%] | 7.2 x 5.3 7.2 x 5.3 (1/1.8") 0.05 |
| max. object size [mm] at a chip size of [mm] distorsion [%] | --- 8.8 x 6.6 (2/3") --- |
| numerical aperture | 0.05 |
| max. outside-Ø [mm] | 45.0 |
| length [mm] (+/-2%) | 203.8 |
| weight [kg] | 0.6 |
| | |
| | |

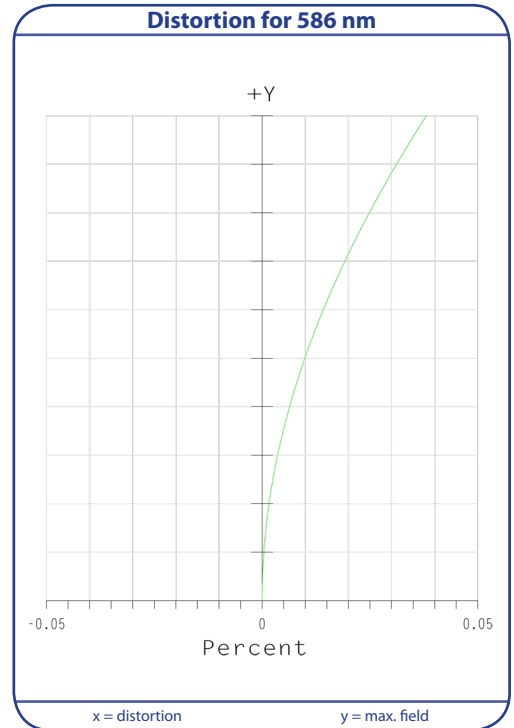

T.. Tangential

MTF for various object heights at 586nm

S.. Sagittal

